

PLAN SHOWING THE PROPOSED CONSTRUCTION OF RESIDENTIAL BUILDING IN S.No: 7/7, GENGUREDDY KUPPAM OF TIRU. NINRAVUR VILLAGE & TOWN PANCHAYAT LIMIT. SRIPERUMBUDUR TALUK, CHENGAI ANNA DISTRICT.

Scouting plan (Seal plan)

18/11/90

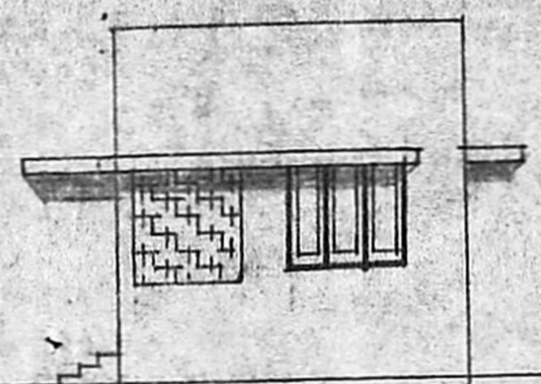

FRONT ELEVATION FACING NORTH

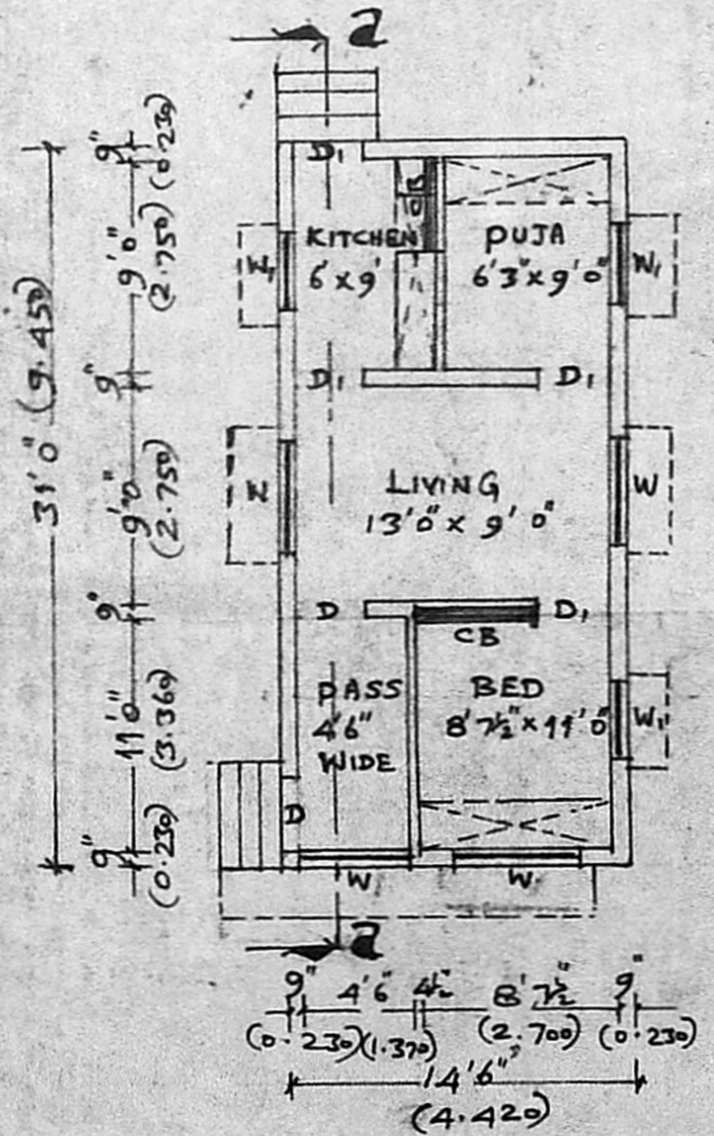

PLAN

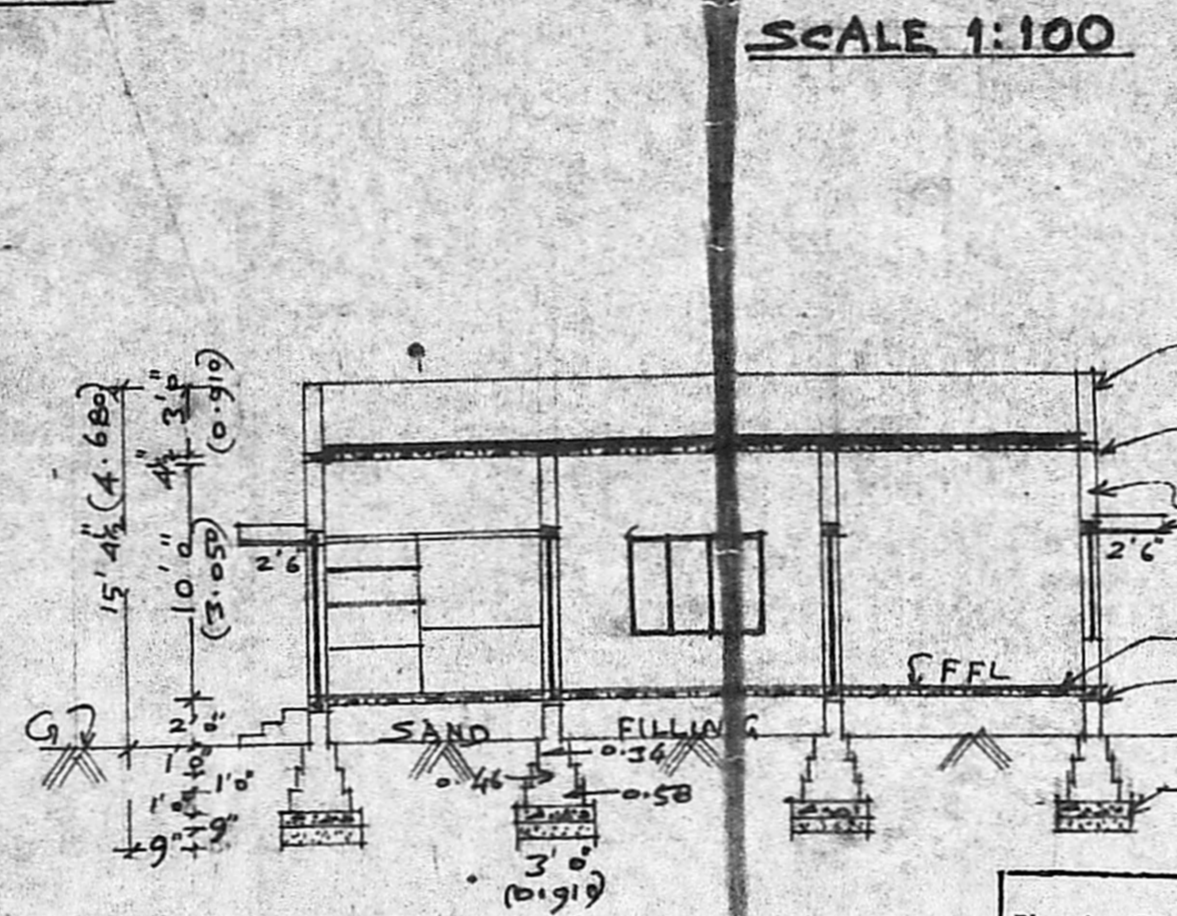

SECTION ON '22'

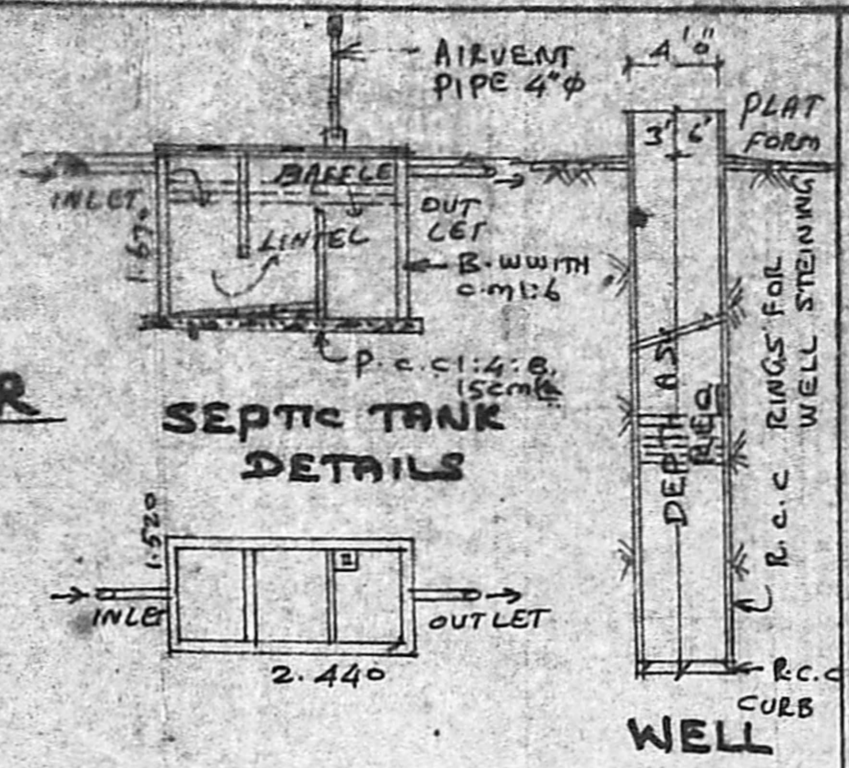

BRIEF SPECIFICATION	
FOUNDATION	P.c.c. 1:4:8 OVER SAND FILLING. FOOTINGS WITH BRICK WORK IN c.m: 6
BASEMENT & SUPER STRUCTURE	BRICK WORK WITH c.m: 6
ROOFING	R.c.c. 1:2:4 ROOF SLAB 12cm ϵ & WEATHERING COURSE WITH BRICK JELLY LIME ON TOP
PLASTERING	c.m: 4, 12mm ϵ
FLOORING	P.c.c. 1:4:8, 10cm ϵ & FINISHED WITH c.m: 4, 12mm 20mm ϵ
JOINERIES	1ST CLASS HARD WOOD

SCHEDULE OF JOINERIES	
D	COUNTRY WOOD DOOR 3'3" x 7'0"
D1	" " 3'0" x 6'8"
D2	" " 2'6" x 6'8"
W	COUNTRY WOOD GLAZED WINDOW 5'0" x 4'6"
W1	" " 3'3" x 4'6"
CB	CUP BOARD

AREA STATEMENT	
AREA OF SITE	2180 SQFT (OR) 202.522m ²
AREA OF PROPOSED CONSTRUCTION	450 SQFT (OR) 41.805m ²
COVERAGE	20.64%
F.S.I	0.217

LEGENDS	
PROPOSALS SHOWN IN	—
EXISTINGS SHOWN IN	—
BOUNDARY OF SITE	—

Planning Permit No. A/259/90
APPROVED
 SUBJECT TO THE CONDITIONS IN THIS ORDER.
 No. D.D. A/2450/90, 20-3-90
 o/c. C.R. Vimala
 FOR ME 13/11/90
 MADRAS MUNICIPALITY
 DEVELOPMENT AUTHORITY
 MADRAS 600 009

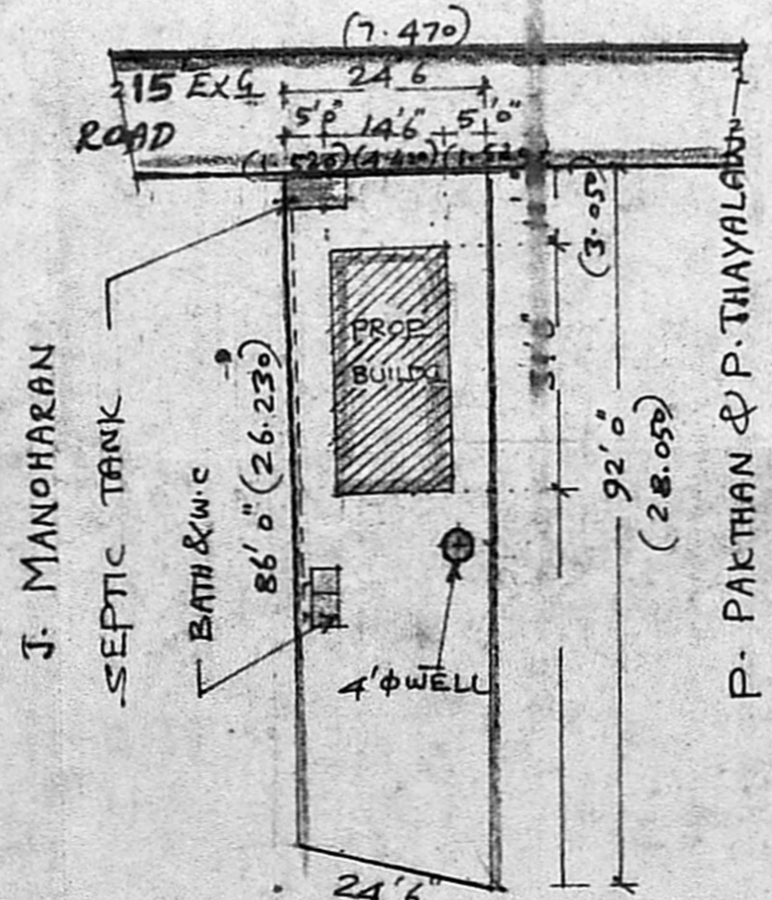

SITE PLAN
SCALE 1:300 D. HENDRI LAND

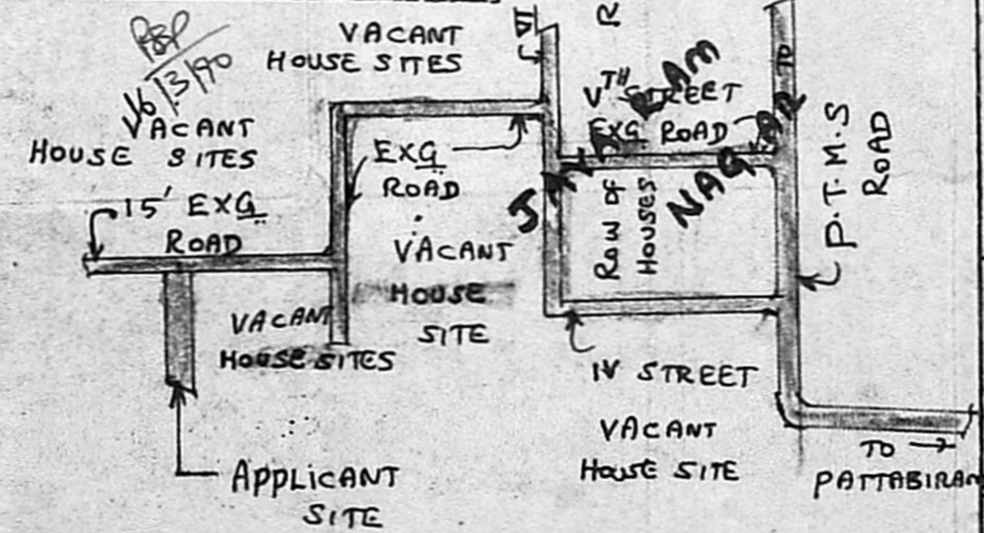

KEY PLAN
(NOT TO SCALE)

P. Kaliappan
(P. KALIAPPAN)
 OWNER

K. Shanmuga Sundaram
K. Shanmuga Sundaram, D.C.R.E
 LICENCED SURVEYOR & CONSULTING ENGINEER
 Thiruninravur Panchayat
 369, M. T. H. Road,
 Thiruninravur, R. S-602 024.

LICENCED SURVEYOR